

Reference report

Contact person

Matthias Fischer

+49 371 2371-196 +49 371 2371-150

Email: matthias.fischer@sigma-chemnitz.de

Internet: www.sigma-chemnitz.de/en

About SIGMA

As a reputable system house in Saxony SIGMA Chemnitz GmbH operates as system integrator and partner of well-known Providers in the IT sector. Our over 80 employees at the Chemnitz and Dresden sites form a competent team at the location Chemnitz. With expertise, competence and almost 30 years of experience we offer our customers reliable and powerful solutions.

About our Embedded Team

The Embedded Team of SIGMA Chemnitz works hardware, platform and processor independent and can refer to a large number of references around Windows Embedded, Embedded Linux and Android.

Our customers appreciate us as competent, innovative, and highly skilled partner, who will support you from the first problem analysis committed to the goal accompanied. Many years of project experience of our employees form the foundation for effective solutions on the latest state of the art technology.

Especially in the field of Windows Embedded we number amongst the last, who still provide development services for this purpose. For the assurance of quality-oriented services of our company work, we strictly follow a quality management system. Since 1996 we have been continuously certified according to DIN ISO 9001:2015.

Technical Facts

Operation system:

- WinCE7

Processor:

- Toradex Nvidia Tegra T20

About our embedded service

- Repair attempt of an mPulse Handheld LIBS Metal Analyzer

Repair attempt mPulse Handheld LIBS Metal Analyzer



www.schrott-nasz.de

About Schrott-Nasz GmbH

The company Schrott-Nasz GmbH has set itself the task of transferring recyclable materials to industrial recycling. To this end, worthless residues and environmentally harmful substances are separated and disposed of professionally. This makes a valuable contribution to non-renewable raw materials and to the preservation of our environment.

The problem

The mPulse metal analyzer used by the company no longer functioned.

Unfortunately, the manufacturing company didn't exist anymore.

Successors no longer offer to repair the mPulse and Schrott Nasz's own repair attempts failed. SIGMA was the only company that dared to attempt a repair on request.

One of the causes of the device failure was the uncontrolled switching off of the device by disconnecting the power supply unit due to a missing battery (defective) and the occasional destruction of data structures on the internal flash, which is common for many devices. The control module comes from Toradex.

An Nvidia Tegra T20 ARM SoC is installed.

A lot of experience and know-how, fun in troubleshooting, measurements, tools available from Toradex and a little luck the data structures could be saved and restored and the application could be restarted again. The display, which was also defective, was replaced.

Conclusion

The final success is still pending, as apparently parts of the hardware and/or software are not working

together as required. We are continuing our search and will report in an update if we are successful.

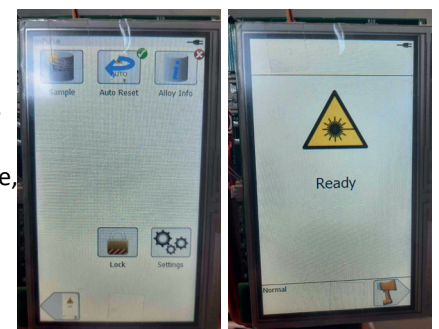

This is what our customer says...

„SIGMA was the only company that was prepared to take on our problem. Even though the device is not yet fully functional again - the computer unit including the display could be put back into operation, as well as the application. We are still working hard to find a complete solution.“

An employee at Schrott Nasz GmbH